

PIER CAP SECTION

ISSUED: 2009

PLATE
3.5-3

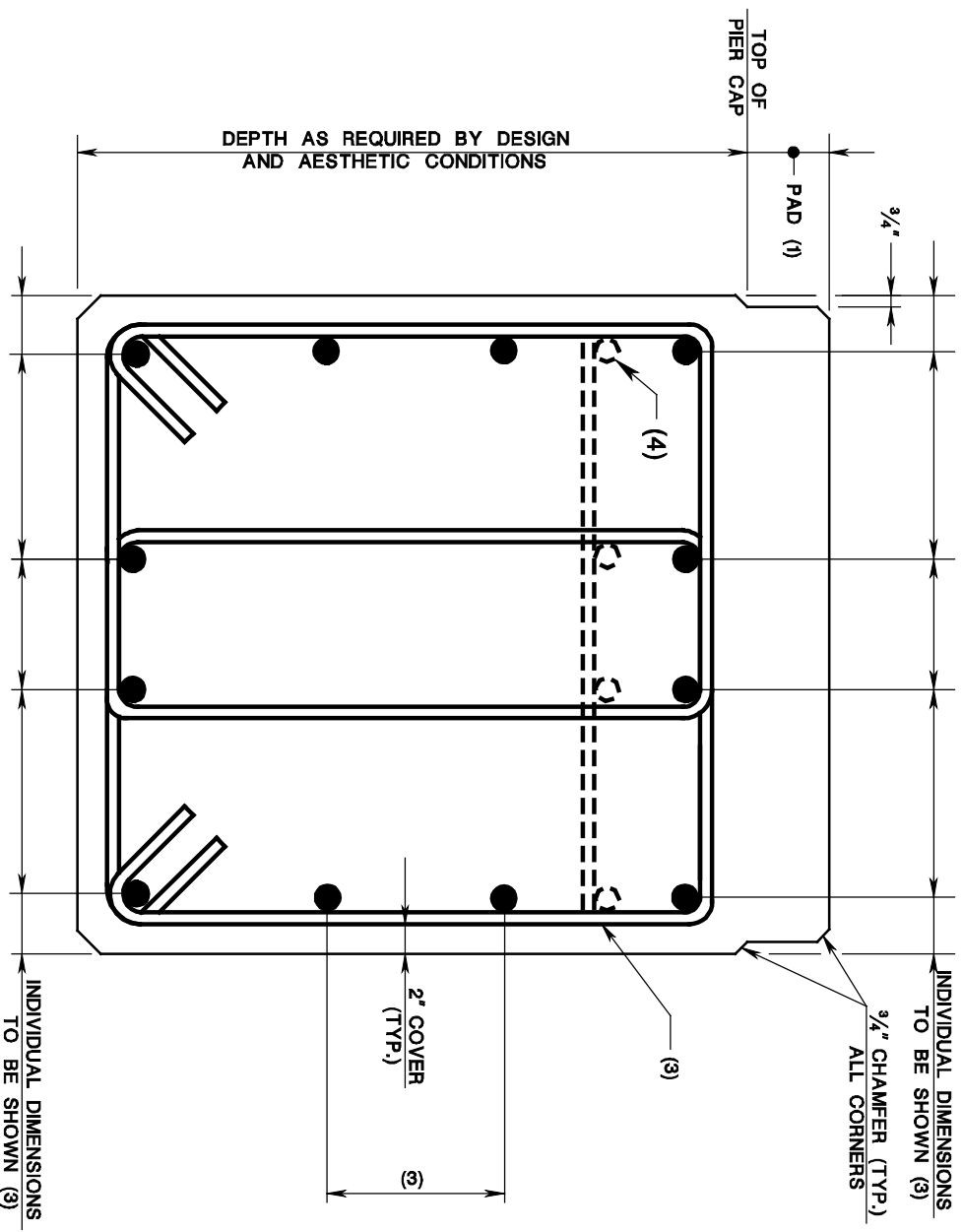

1. PROVIDE GRILLAGE SIMILAR TO THAT SHOWN ON PLATE 3.3-1 FOR PADS OVER 3' HIGH. GRILLAGE BARS UNDER DECK JOINTS SHALL BE CORROSION PROTECTED.
2. SEE SUBSECTION #9.4. (INDIVIDUAL PIER CAP SECTIONS SHALL BE SHOWN FOR EACH CHANGE IN SIZE AND/OR SPACING OF BARS).
3. REINFORCEMENT STEEL SIZE AND SPACING AS REQUIRED BY DESIGN.
4. USE 2 OR MORE ROWS IF REQUIRED BY DESIGN OR AS REQUIRED TO FACILITATE PLACING OF CONCRETE AND/OR ANCHOR BOLT SLEEVES.
5. PIER CAPS UNDER DECK JOINTS SHALL BE TREATED WITH EPOXY WATERPROOFING SEAL COAT, LIMITS OF TREATMENT SHALL BE AS INDICATED ON BRIDGE CONSTRUCTION DETAILS.